

EMERGENCY LIGHTING TESTING

Months 1 to 11 inclusive – Function test, interrupt the permanent/unswitched supply and check the luminaire operates in emergency mode at reduced output

Month 12 (Annual) – As months 1 to 11 but for a full 3 hour duration

Luminaire Ref / Location: .....	In case of difficulty, contact the installation engineers:- Tel: .....	
Full recharge time 24 hours	Duration 3 hours	Lamp type - LED

ROUTINE TEST RECORD										
	Year 1		Year 2		Year 3		Year 4		Year 5	
Monthly test	Signed	Date	Signed	Date	Signed	Date	Signed	Date	Signed	Date
Functional										
Functional										
Functional										
Functional										
Functional										
Functional										
Functional										
Functional										
Functional										
Functional										
Functional										
3 Hour										

WARRANTY

Products are protected by warranty for a period of 3 year warranty, from date of purchase against defects in material and workmanship (unless otherwise stated). Should a product fail to perform as described within the warranty period it will be repaired or replaced with the same or equivalent product by Luceco, free of charge provided that you: (1) return the product to us with shipping charge prepaid, (2) provide us with proof of the original date of purchase and (3) quote our return authorization number.

Repaired or replaced products will be returned to you with shipping charges prepaid. Replacement products may be refurbished or contain refurbished materials. If in our sole discretion, we are unable to repair or replace a defective product, we will refund the purchase price of the product.

This warranty will not apply if in our judgment, the product fails due to damage in shipment, handling, storage, accident, abuse or misuse, or if it has been used in a manner not conforming to our product instructions, has been modified in any way, or has any serial number removed or defaced. Repair or attempted repair will void this warranty. Our maximum liability under the terms of this warranty is limited to the purchase price of the product covered by the warranty.

The warranty is given under English Law. If any part of this warranty is deemed unenforceable (including any provision in which we exclude our liability to you) the enforceability of any other parts of the warranty will not be affected. These terms do not reduce your statutory rights.

THESE TERMS AND CONDITIONS ARE SUBJECT TO CHANGE WITHOUT PRIOR NOTICE

For further details, terms and conditions and online registration please see [www.luceco.uk](http://www.luceco.uk)

INSTALLATION – NON DIMMING

Turn OFF power supply, ensure all required equipment and tools are present.

The Emergency Pack is supplied pre-wired for easy connection to luminaires and drivers. 5 connections need to be made:

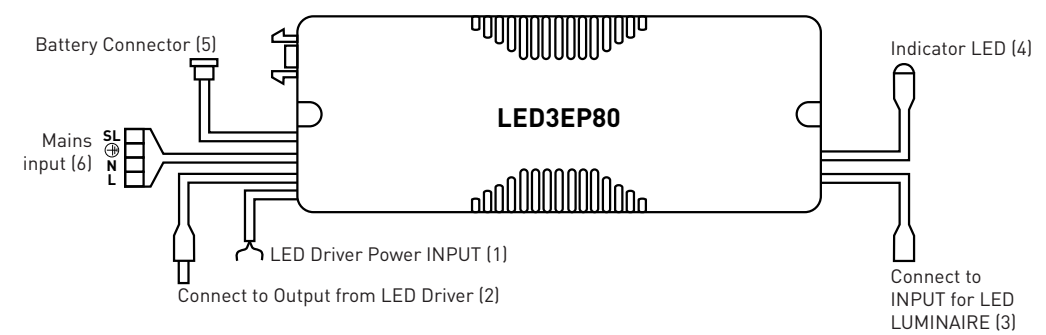

CONNECTING THE DRIVER (1 & 2)

Due to ongoing product improvements, some emergency packs may require use of the included adaptors to connect to your Luceco luminaires. Use supplied adaptors to Connection 2 and 3, as required to connect to your Luceco luminaire.

The emergency pack is supplied pre-wired for connection to the LED driver supplied with the luminaire. Use the L/N cable from the emergency pack (1) as the input for the LED driver, and connect the pre-wired connector from output of the driver to input for emergency pack (2). Remove Safety covers before installation.

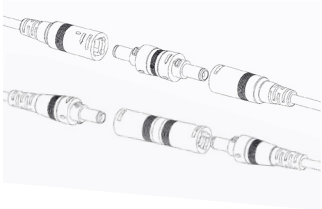

LUMINAIRE INPUT (3)

Connect the lead from emergency pack to the connector on luminaire. Align arrows, push together and twist to lock.

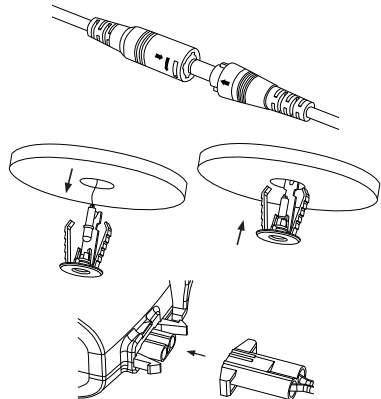

INDICATOR LED (4)

Drill a 18mm hole close to the installation location of the luminaire. Feed the indicator cable through the cut out, insert into the housing then push both into the ceiling until secure.

BATTERY (5)

Push the battery connector together, ensuring correct polarity. **DO NOT FORCE PLUG. NOTE** - the luminaire may illuminate due to any stored battery charge.

MAINS INPUT (6)

The emergency pack requires a permanent, switched live and neutral. Earth is not required as the case is Class 2, but provision has been given for a loop through for earth. Connect to 4 way connection block as per labelled.

## DIMMABLE DRIVER CONNECTION (DALI)

For use with DALI drivers, Please connect DALI leads direct to Driver DALI in, as per Standard installation.

Please Note - This is not a DALI Emergency Pack and has no further DALI functionality.

## FOR USE WITH DIMMABLE DRIVERS, AN ADDITION SINGLE CORE CABLE IS REQUIRED

For Use with Dimmable Drivers, An additional single core cable is required

Dimming is only suitable with retractive switches and/or DALI

1. Open Connection Block, Move existing Switched Live from SL to L(Permanent Live)
2. Add Additional Single Core cable (400-600mm) into SL terminal,
3. Connect New Switched Live to Switch Dim L on Driver. A small bridge cable is required from main Neutral to Dim N.
4. Connect L/N from Emergency pack to Driver, and follow instructions as normal.

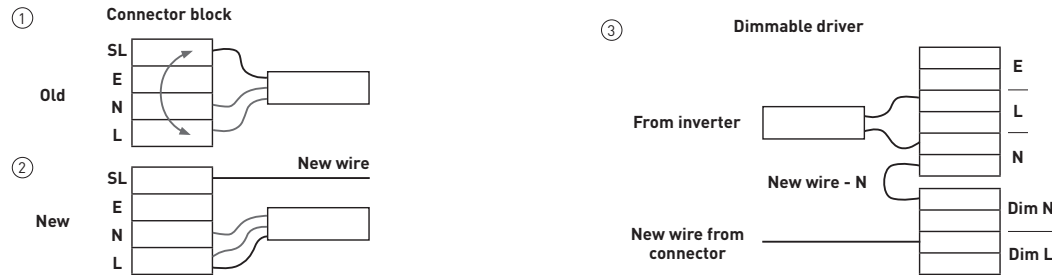

## TESTING/COMMISSIONING

- Ensure the load is connected.
- Connect the battery.
- Switch on the unswitched supply - Check the charge LED illuminates.
- Switch on the maintained supply - Check the LED illuminates as normal.
- Switch off the maintained supply.
- Switch off the unswitched supply - Check the charge LED extinguishes and the load LED illuminates at a reduced output.
- Enter the commissioning date on the battery pack.
- Switch on the unswitched supply
- From Initial installation the intergral batteries will require 36 hours to reach full charge status

## ENVIRONMENTAL PROTECTION W.E.E.E

This symbol is known as the "crossed-out wheeie Bin Symbol". When this symbol is marked on a product or battery, It means that it should not be disposed of with your general household waste. Some chemicals contained within electrical/electronic products or batteries can be harmful to health and the environment. Only dispose of electrical/electronic/battery items in separate collection schemes, which cater for the recovery and recycling of materials contained within. Your co-operation is vital to ensure the success of these schemes and for the protection of the environment.

## TECHNICAL INFORMATION

Code	LED3EP80
Dimensions	245mm x 95mm x 40mm
Total Weight	0.9Kg
Supply Voltage	230/240 Volts AC 50/60 Hz
Power Rating	4 Watts
Power Factor	0.8
Duration	3 hours
Ambient Temp	0°C to + 55°C
Max Case Temperature *	70°C
Max Battery Temperature	55°C
Battery Fuse	Internal
Battery Pack	3.6V/4.5Ah Ni-Cd
Charge Current	170mA
Recharge Period	36 Hours

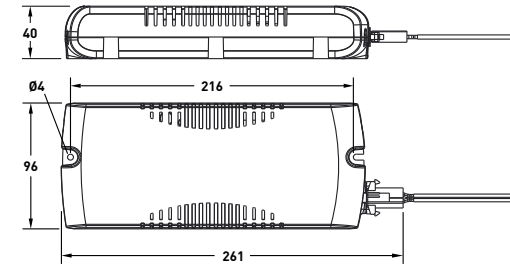

- From initial installation the integral batteries will require 36 hours to reach full charge status.
- Following a full discharge, 24 hours should be allowed for the batteries to re-charge.
- The green LED charge indicator signifies that the batteries are charging and will remain illuminated when the luminaire is switched off.
- The batteries have a rated service life of 4 years and should be checked and considered for replacement at that point.
- A record of routine testing should be kept to ensure emergency luminaires are maintained and operated correctly.
- The battery has a 4 year service life provided it is operated and maintained by regular testing, as detailed in this document. Failure to maintain or change the battery may result in reduced duration in emergency mode.

## SPECIFICATIONS

- Suitable for use with Mains voltage of 230/240V AC
- This product must be disconnected before insulation resistance testing of the lighting circuit
- Check for electrical cables and pipes before installation

**NOTE** – To comply with regulations, Installation must be carried out by suitably qualified competent person and in accordance with the current IEE Wiring Regulations (BS7671) and Building Regulations. The Emergency pack requires 2 Live feeds, 1 to charge the battery pack and 1 for switching of the product.

**ENSURE ELECTRICAL SUPPLY AND BATTERY CONNECTION IS DISCONNECTED/ISOLATED BEFORE COMMENCING INSTALLATION OR ANY MAINTENANCE WORK. HIGH VOLTAGE COULD BE PRESENT AT THE OUTPUT CONNECTION IF THE BATTERY IS NOT DISCONNECTED.**

**WARNING - AVOID RUNNING THE LED MAINS DRIVER AND EMERGENCY PACK WITHOUT THE LOAD CONNECTED. FAILURE TO DO SO MAY RESULT IN DAMAGE TO THE LED EMERGENCY PACK.**

**NOTE** - This Emergency Pack is only suitable and guaranteed for use with Luceco luminaires.

