

# KUDOS



Centrifugal WC, Bathroom, Kitchen & Utility Room Fans



The KUDOS range of 100mm centrifugal extract fans are suitable for many domestic ventilation applications. The KUDOS 100 is ideal for WC and bathroom ventilation, whilst the 170 is ideal for utility room applications and the 250 for kitchens. Each model is available in standard, timer or humidity sensor options. The KUDOS fans incorporate powerful forward curved centrifugal impellers delivering high airflow performances.

## Features

- Sealed for life ball bearings
- Two speed
- Numerous quality features
- IP44 rated
- Metal filters
- Backdraught shutters
- Two year guarantee

## Benefits

- High performance
- Significant energy savings
- Complies with building regulations
- Can be surface or recessed mounted

## Optional Features



### Adjustable Over Run Timer

After disconnection, the shut off time can be delayed between 1 and 30 minutes.



### Internal Humidity Sensor

Internal humidity sensor which automatically switches on the unit when the relative humidity rises above the selected set level; pullcord or remote switch.

## Standard Features



### Backdraught Shutter

The KUDOS extract fans are fitted with an automatic backdraught shutter to prevent air entry and limit heat leakage when the extractor is not operating.



### Forward Curved Centrifugal Impeller

To deliver high airflow performances with a minimum of noise generation against high static pressure system resistance.

ORDER CODE	KUDOS100S	KUDOS100T	KUDOS100HT	KUDOS170S	KUDOS170T	KUDOS170HT	KUDOS250S	KUDOS250T	KUDOS250HT
Backdraught Shutter	•	•	•	•	•	•	•	•	•
Metal Filters	•	•	•	•	•	•	•	•	•
Two Speed	•	•	•	•	•	•	•	•	•
Adjustable Over Run Timer		•	•		•	•		•	•
Internal Humidity Sensor			•			•			•

## Application Suitability

Model	Application	Trickle Speed	High Speed	Building Regulation Requirements
KUDOS 100	Bathroom	20 l/s	36 l/s	15 l/s
KUDOS 170	Utility	38 l/s	61 l/s	30 l/s
KUDOS 250	Kitchen	52 l/s	75 l/s	60 l/s

## Controllers



### REB

The KUDOS range can be controlled with the REB single phase electronic speed controller.

## Installation Options ▼

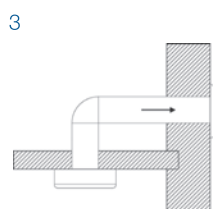
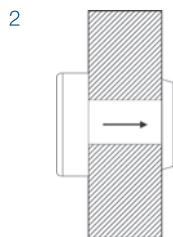
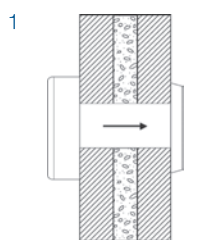

- 1 Extract ventilation through double walls using the EnviroVent 100mm wall kit
- 2 Ceiling or wall mounting extract ventilation
- 3 Extract ventilation through short duct

## Options &amp; Ancillaries ▼

Description	Code(s)
Standard Wall Kit	1RDEFWAK100
High Rise Installation Kit	1RDEFPTK
Ø100 Flexible Hose Ducting	1RDFLEX100X3M
Flat Channel Ducting	1FD110X541M
Fixed Louvre Grille	1RDGRILL100
Fixed Louvre Grille - Multi Fit	1MFFIXLOUV
Airbrick Adaptor to Round Ducting	1ADAIRBRICK100
Slimline Airbrick	1FDHORLOUV
Condensation Trap	1RDCONTRAP100
Worm Drive Clips	IN-WDC100
Duct Insulation Sleeve	1RDSLINS100

## Dimensions (mm) ▼

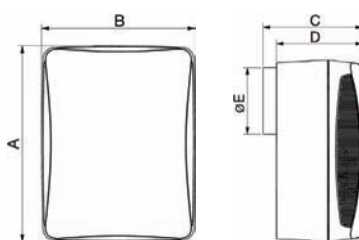

	KUDOS 100	KUDOS 170	KUDOS 250
A	260	322	322
B	205	282	282
C	160	170	170
D	130	156	156
ØE	98	98	98

## Performance Curves ▼

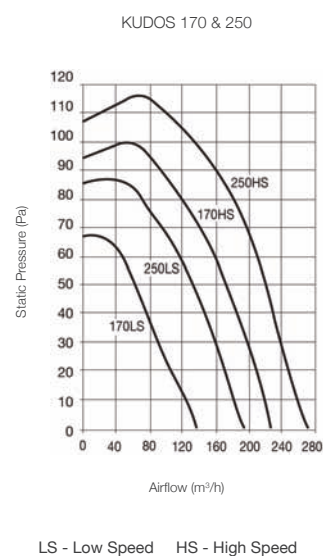
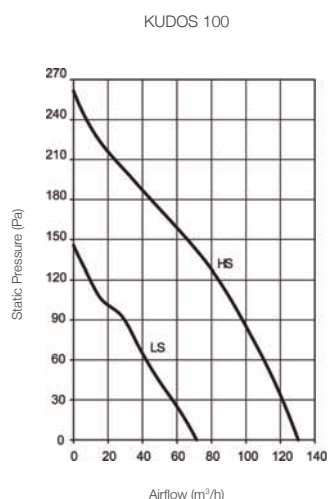

## Technical Specification ▼

## Product

The KUDOS range fans are centrifugal extract fans ideally suited for general domestic ventilation. The fans are fitted with an automatic backdraught shutter as standard.

## Performance

MODEL		KUDOS 100	KUDOS 170	KUDOS 250
Speed (r.p.m.)	LS	1050	1010	1225
	HS	1600	1010	1225
Watts (W)	LS	15	48	51
	HS	35	48	51
Voltage (V) 50Hz		230-240	230-240	230-240
Airflow l/s (m³/h)	LS	21 (75)	38 (136)	52 (187)
	HS	36 (130)	61 (220)	75 (270)
dB(A) @ 1.5m	LS	34	42.3	46
	HS	46	42.3	46
Weight (Kg)		1.8	3	3
IP Rating		IP44	IP44	IP44
Ø Duct (mm)		100	100	100

## Installation

Full installation guide is enclosed with all products; or sent separately in advance - if required.

## Applications

The KUDOS range can be either surface or recessed mounted in a wall or ceiling. The KUDOS 100 is ideally suited for WC and bathroom ventilation. The KUDOS 170 is suitable for utility room ventilation and the KUDOS 250 for kitchen ventilation.

## Motor

Is a 230V 50Hz A/C 2-pole motor.

## Fan

Incorporates a powerful forward curved centrifugal impeller to deliver high performance against high static pressure resistance.

## Servicing &amp; Maintenance

The fans can be cleaned by removing the front section and washing the filters in a sink in soapy water. Ensure that the parts are completely dry before re-assembling.

## Guarantee

Is covered by a 2 year warranty subject to the specified maintenance.

## Compliance

CE

## Related Information ▼

Description	Page Number(s)
Domestic Ancillaries	130-135
Wiring Diagrams	150-151